



art metal K4 CERES

F.P.H. Art Metal Sp.j.

Ul. Jabłoniowa 124, 83-331 Łapino Kartuskie, Poland
Tel. 0048 58 681 80 78, Fax: 0048 58 681 80 64
www.art-metal.pl e-mail: biuro@art-metal.pl

Construction:

The unit consists of a tray (1) holding a igniter module (2) and a lampholder (3). The tray is covered by a housing (4) which protects an igniter module (4). A RASTER reflector (ODB-3) can be additionally fixed. There is a bulb (6) placed in the lampholder. The lantern is closed with a shade (7), mounted in a lantern thread supported by a setting bolts. There is a cap (9) mounted on the top of the shade. Tightness of the construction is provided by gaskets (8).

Mounting instructions:

- *)-Fix the igniter (2) and the lampholder (3) to the base (1).
- Carry the electric wires out of the bracket and place them inside the lantern. Attach to the igniter (2).
- Place and fix the housing of the igniter with a gasket (8).
- Fix the base (1) to the bracket.
- Place the bulb (6).
- Place the RASTER reflector.
- Mount and secure the shade (7).

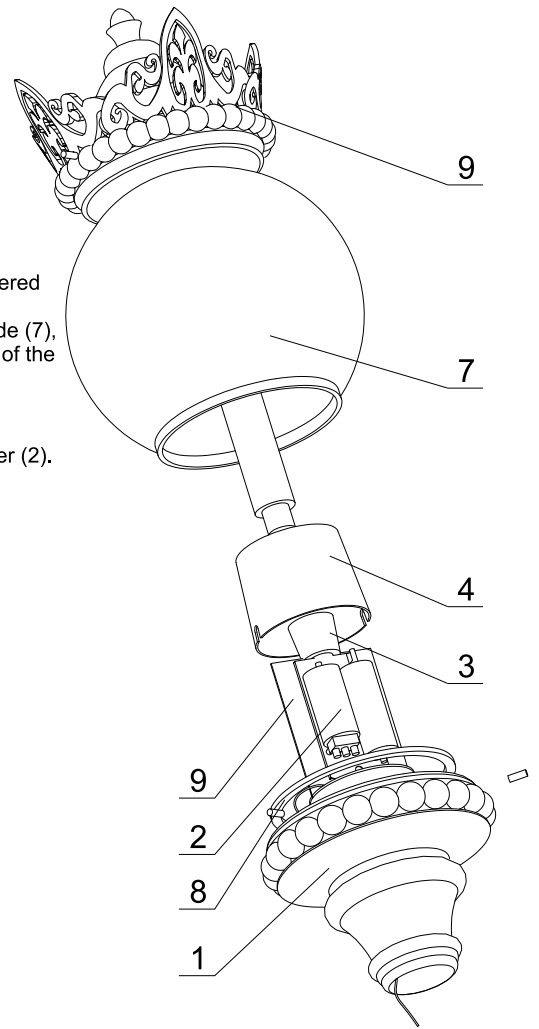

If any lantern elements are supplied factory-mounted, the mounting stages marked with *) should be omitted (as this has already been done by the manufacturer)

TECHNICAL DATA:

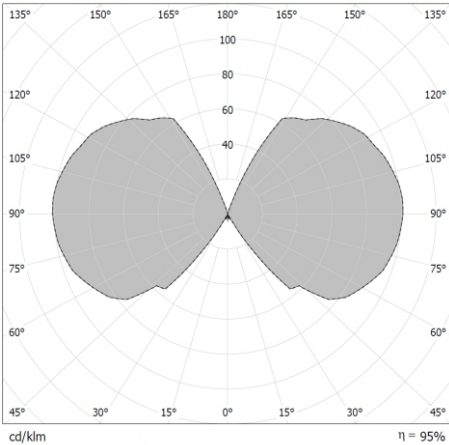

Photometry (polar plot)

Power: ~230/50Hz

Protective class: I

IP65 -electrical part

IP65 -optical part

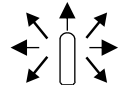
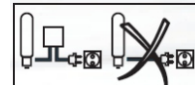
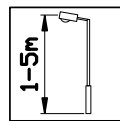

ELECTRICAL DIAGRAM:

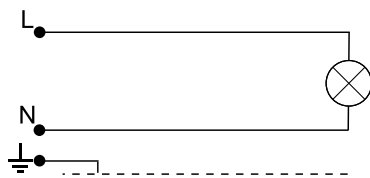

1. Incandescent bulb

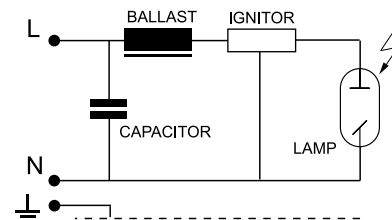

2. Sodium / metal halide lamps

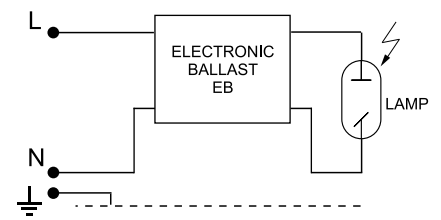

3. Sodium / metal halide lamps

Type	Light-producing element	Lamp holder	Weight [kg]	Pn [W]		Luminary dimensions
				IC	EB	
K4MH-70W	MH/HSI/HPI	E27	7,8	81	78	<p>Wind area A = 0,17m²</p> <p>H/D 750/400</p>
K4MH-100W	MH/HSI/HPI	E27	8,3	114	109	
K4S-70W	WLS/SHP/SON	E27	7,8	81	78	
K4S-100W	WLS/SHP/SON	E40	8,4	114	109	
K4Z-E/Z	Bulb / MINI - LINX	E27	6,3	Max. 60		

WARNING !! The weight of the unit may slightly differ for individual production batches.

